

Media: air – water – light oil – 80% vacuum
 Pressure range: 0 to 16 Bar max
 Media temperature: -40°C to +150°C max
 Ambient temperature: -20°C to +60°C max
 Media viscosity: 50 centistokes max
 Mounting: coil upright
 Opening / Closing Time: 50 mSec Max

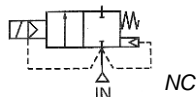

2/2 Stainless Steel

3/8 – 3/4

NORMALLY CLOSED

2 WAY ZERO RATED

0 - 7 or 0 - 12 Bar

TYPE SPU220®



PRESSURE

| Ø Port BSP | Ø Orifice (mm) | Flow Kv Ltr/min | Pressure Rating (Bar) | | | | Seals | Max Media Temp. °C | Part Number | |
|------------|----------------|-----------------|-----------------------|---------|----|-----------|--------------------------|---|---|--|
| | | | Min | 15 Watt | | 18.5 Watt | | | | |
| | | | | AC | DC | AC | | | | DC |
| 3/8 | 13 | 35 | 0 | 7 | 5 | | NBR -15°C to +80°C | SPU22003V + voltage SPU22003 + voltage SPU22003E + voltage | | |
| 1/2 | 13 | 35 | 0 | 7 | 5 | | | SPU22004AV + voltage SPU22004A + voltage SPU22004AE + voltage | | |
| 3/4 | 20 | 72 | 0 | 7 | 5 | | Viton -10°C to +180°C | SPU22006AV + voltage SPU22006A + voltage SPU22006AE + voltage | | |
| 3/8 | 13 | 35 | 0 | | | 12 | | 12 | FKM NBR EPDM | SPU22003V + voltage + 18.5W SPU22003 + voltage + 18.5W SPU22003E + voltage + 18.5W |
| 1/2 | 13 | 35 | 0 | | | 12 | 12 | FKM NBR EPDM | SPU22004AV + voltage + 18.5W SPU22004A + voltage + 18.5W SPU22004AE + voltage + 18.5W | |
| 3/4 | 20 | 72 | 0 | | | 16 | 16 | FKM NBR EPDM | SPU22006AV + voltage + 18.5W SPU22006A + voltage + 18.5W SPU22006AE + voltage + 18.5W | |

OPTIONS

22003 IP65 CE approved 15-Watt Coil & Connector PG9 – DIN 43650 A Connector
 22005 IP65 CE approved 18.5-Watt Coil & Connector – DIN 43650 A Connector
 ATEX 22003EX Coil: ATEX EExmIIT4 II 2G & 2D IP65 T130°C (Max 0-3 Bar)
 NPT Thread
 Normally closed operator with silver shading ring (AC or DC) RO + pure water (113-010-0045)
 Normally closed operator without shading ring (DC voltages only or with rectified connector AC to DC)
 HNBR seals, degreased, flanged

ELECTRICAL DATA

| Voltage (-10% + 10%) Continuous duty 100% | | Coil | Power Consumption | | Insulation class | Enclosure | Electrical connections |
|--|---------------------------------|-------|-------------------|---------|------------------|----------------------------|---|
| ~ | = | | Inrush | Holding | | | |
| ~ | 12-24-48-110-240-380 (50/60 Hz) | 22003 | 23VA | 17VA | H 180°C | IP 65 with connector | 3 spades DIN 43650A DIN 40050 VDE 0110 |
| = | 12-24-48-110-220 (DC) | | 15 Watts | | | | |
| ~ | 24-48-110-230 (50/60 Hz) | 22005 | 33VA | 24VA | | | |
| = | 12-24-48-110-220 (DC) | | 18.5 Watts | | | | |

CONSTRUCTION

Body: 316 Stainless steel (1/2 & 3/4 ATEX certified body)
 Tube and internal parts: Stainless steel, shading ring copper (option silver or without)
 Seals and gaskets: FKM (Optional EPDM, NBR or HNBR)
 Nass Magnet Moulded coil: DuroPlast / ThermoSet Resin

REPAIR KIT

| | |
|----------|--|
| Seal kit | ZGPU220A + size code (03-06) + seal material |
| Coil | Coil size (22003 or 22005) + voltage |

OVERALL DIMENSIONS

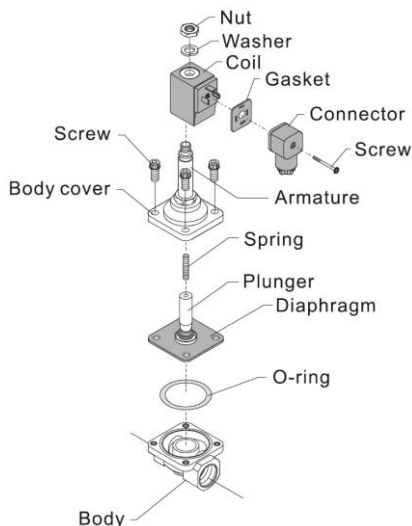

| Model | SPU220 03 | SPU220 04A | SPU220 06A |
|--------|-----------|------------|------------|
| Port G | 3/8 | 1/2 | 3/4 |
| A | 66.5 | 66.5 | 71.0 |
| B | 101.0 | 101.0 | 107.0 |
| C | 48.0 | 48.0 | 58.0 |
| Kg | 0.74 | 0.715 | 0.945 |

