

Media: air – water – light oil - vacuum
 Pressure range: 0 to 7 or 12 Bar max
 Media temperature: -40°C to +180°C max
 Ambient temperature: -20°C to +60°C max
 Media viscosity: 50 centistokes max
 Mounting: coil upright
 Opening / Closing Time: 50 mSec Max

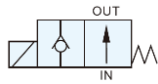

2/2 Brass

3/8 – 1”

NORMALLY OPEN

2 WAY ASSISTED LIFT

0 - 7 or 0 - 12 Bar

TYPE NOPU220



PRESSURE

Ø Port BSP	Ø Orifice (mm)	Flow Kv Ltr/ min	Min	Pressure Rating (Bar)			Max Media Temp. °C	Seals	Part Number
				AC Coil		DC Coil			
				15 Watt	18.5 Watt	18.5 Watt			
3/8	13	35	0	7			NBR -15°C to +80°C EPDM -5°C to +130°C Viton -10°C to +180°C HNBR -40°C to +150°C	NBR	NOPU22003 + voltage
				7				FKM	NOPU22003V + voltage
								EPDM	NOPU22003E + voltage
1/2	13	35	0	7				NBR	NOPU22004A + voltage
								FKM	NOPU22004AV + voltage
								EPDM	NOPU22004AE + voltage
3/4	20	72	0	7				NBR	NOPU22006A + voltage
								FKM	NOPU22006AV + voltage
							EPDM	NOPU22006AE + voltage	
1	25	183	0	7			NBR	NOPU22008A + voltage	
							FKM	NOPU22008AV + voltage	
							EPDM	NOPU22008AE + voltage	
3/8	13	35	0		12	12	NBR	NOPU22003 + voltage + 18W	
							FKM	NOPU22003V + voltage + 18W	
							EPDM	NOPU22003E + voltage + 18W	
1/2	13	35	0		12	12	NBR	NOPU22004A + voltage + 18W	
							FKM	NOPU22004AV + voltage + 18W	
							EPDM	NOPU22004AE + voltage + 18W	
3/4	20	72	0		12	12	NBR	NOPU22006A + voltage + 18W	
							FKM	NOPU22006AV + voltage + 18W	
							EPDM	NOPU22006AE + voltage + 18W	
1	25	183	0		12	12	NBR	NOPU22008A + voltage + 18W	
							FKM	NOPU22008AV + voltage + 18W	
							EPDM	NOPU22008AE + voltage + 18W	

OPTIONS

22003 IP65 CE Approved Coil & Connector PG9 – DIN 43650 A Connector ATEX 22003EX Coil: ATEX EExmIIT4 II 2G & 2D IP65 T130°C (Max ΔP 3 Bar) NPT Thread HNBR seals, degreased or flanged	Included
---	-----------------

ELECTRICAL DATA

Voltage (-10% + 10%) Continuous duty 100%	Coil	Power Consumption		Insulation class	Enclosure	Electrical connections
		Inrush	Holding			
~ 12 - 24 - 48 - 110 - 240 - 380 (50/60 Hz)	22003	23VA	17VA	H 180°C	IP 65 with connector	3 spades DIN 43650A DIN 40050 VDE 0110
= 12 - 24 - 48 - 110 - 220 (DC)		15 Watts				
~ 24 - 48 - 110 - 240 (50/60 Hz)	22005	33VA	24VA			
= 12 - 24 - 48 - 110 - 220 (DC)		18.5 Watts				

CONSTRUCTION

Body: Forged Brass SS41
 Tube and internal parts: Stainless steel
 Seals and gaskets: NBR (Optional EPDM, FKM or HNBR)
 Nass Magnet Moulded coil: DuroPlast / ThermoSet Resin

REPAIR KIT

Seal kit	ZGPU220AN + size code (03-08) + seal material
Coil	Coil size (22003 or 22005) + voltage

OVERALL DIMENSIONS

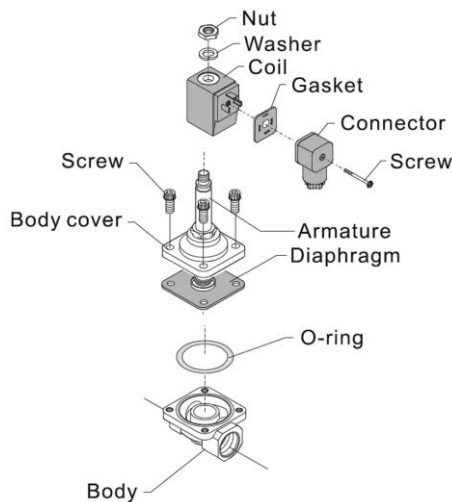

Model	NOPU220 03	NOPU220 04A	NOPU220 06A	NOPU220 08A
Port R	3/8	1/2	3/4	1
A	66.5	66.5	71.0	96.0
B	101.0	101.0	107.0	120.5
C	48.0	48.0	58.0	70.0
Kg	0.74	0.715	0.945	1.485

