

Media: air – water – gas – light oil - vacuum 10⁻⁶ torr
 Pressure range: 0 to 42 Bar max
 Media temperature: +180°C max
 Ambient temperature: -10°C to +50°C max
 Media viscosity: 50 centistokes max
 Mounting: coil upright
 Opening / Closing time: 20 mSec Max

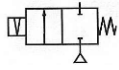

LATCHING

2/2 Stainless

1/8"

LATCHING

2 WAY DIRECT ACTING

0 – 42 Bar

TYPE LADS6000



PRESSURE

| Ø Port BSP | Ø Orifice (mm) | Coil | Flow | Pressure Rating (Bar) | | Seals | Part Number | |
|------------|----------------|------|------------|-----------------------|------|------------------------------------|---------------------------|---------------------------|
| | | | Kv Ltr/min | Min | Max | | | |
| 1/8 | 1.2 | WPG1 | 1.0 | 0 | 21 | NBR +100°C Max | LADS6012 + seal + voltage | |
| | 1.6 | | 1.3 | 0 | 14 | | LADS6016 + seal + voltage | |
| | 2.0 | | 1.6 | 0 | 7 | | LADS6020 + seal + voltage | |
| | 1.2 | WPG2 | 1.0 | 0 | 42 | Silicone EPDM FKM +120°C Max | LADS6112 + seal + voltage | |
| | 1.6 | | 1.3 | 0 | 21 | | LADS6116 + seal + voltage | |
| | 2.0 | | 1.6 | 0 | 10.5 | | LADS6120 + seal + voltage | |
| | 3.0 | | 3.7 | 0 | 7 | | VST +150°C Max | LADS6130 + seal + voltage |
| | 4.0 | | 8.3 | 0 | 4.2 | | | LADS6140 + seal + voltage |
| | 5.0 | | 9.2 | 0 | 3.5 | | | PTFE +180°C |

OPTIONS

IP67 UL + CSA Approved Coil & IP65 LED Connector PG11 – DIN 43650 A
 * PTFE, VST, Neoprene, ECO, HNBR or Hypalon Seals
 Manual Override
 NPT thread
 Other custom-made options upon request

ELECTRICAL DATA

| Voltage (-10% + 10%) Continuous duty 100% | | Coil | Power Consumption | Insulation class | Enclosure | Electrical connections |
|--|--|------|-------------------|------------------|----------------------------|---|
| = 12 - 24 (DC) | | WPG1 | 12 Watts | H 180°C | IP 65 with connector | 3 spades DIN 43650A DIN 40050 VDE 0110 |
| | | WPG2 | 18 Watts | | | |

CONSTRUCTION

Body: 316 Stainless steel
 Tube 304 stainless steel, armature 430F stainless steel, Shading ring None
 Seals and gaskets: FKM (Optional EPDM, NBR, Silicone, PTFE, VST, Neoprene, ECO, HNBR and Hypalon)
 Moulded coil: Resin

REPAIR KIT

| | |
|----------|------------------------------------|
| Coil | Coil size (WPG1 OR WPG2) + voltage |
| Armature | SP210 + Valve Part Number |

OVERALL DIMENSIONS

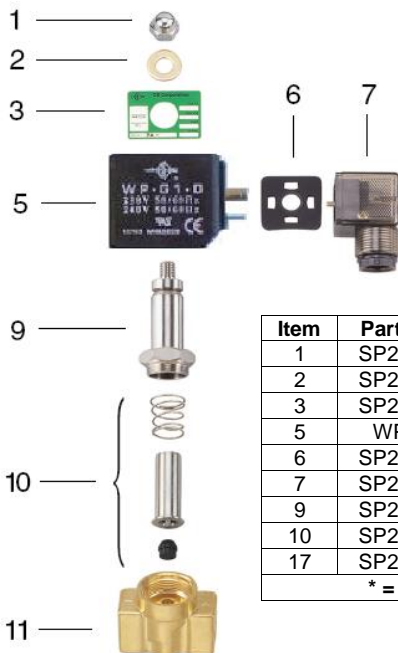

| Model | A | B | C | F | G | H | Kg |
|-----------|----|----|----|----|----|------|------|
| 6012-6020 | 41 | 19 | 85 | 63 | 15 | 10.5 | 0.47 |
| 6112-6150 | 41 | 19 | 88 | 65 | 15 | 10.5 | 0.66 |

| Item | Part No | Description |
|------|---------|-------------------|
| 1 | SP201-* | Nut |
| 2 | SP202-* | Washer |
| 3 | SP203-* | Nameplate |
| 5 | WPG | Coil |
| 6 | SP206-* | Gasket |
| 7 | SP207-* | Connector |
| 9 | SP209-* | Core Tube |
| 10 | SP210-* | Armature Assembly |
| 17 | SP211-* | Valve Body |

* = Valve Part Number

