

Media: air – water – gas – Vacuum  $10^{-3}$   
 Pressure range: 0 to 12 Bar max  
 Media temperature: -10°C +70°C max  
 Ambient temperature: -40°C to +50°C  
 Media viscosity: 50 centistokes max  
 Mounting: coil upright

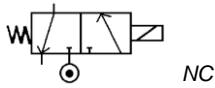

## 2/2 + 3/2 Brass

### EEx ia IIC T/ IEC Ex ia IIC T

### NORMALLY CLOSED

### DIRECT ACTING

### 0 – 8 Bar

## TYPE PU221/ PU321



#### PRESSURE

Ø Port BSP	Ø Orifice (mm)	Flow Kv Ltr/ min	Pressure Rating (Bar)ΔP		Max Working (Bar)	Function	Part Number
			Min	Max			
1/8	0.8	0.3	0	8	12	2/2	PU22101A9T4
1/4	0.8	0.3	0	8	12	2/2	PU22102A9T4
1/8	0.8	0.3	0	8	12	2/2	PU22101A9T6
1/4	0.8	0.3	0	8	12	2/2	PU22102A9T6
1/8	0.8	0.3	0	8	12	3/2	PU32101A9T4
1/4	0.8	0.3	0	8	12	3/2	PU32102A9T4
1/8	0.8	0.3	0	8	12	3/2	PU32101A9T6
1/4	0.8	0.3	0	8	12	3/2	PU32102A9T6

#### OPTIONS

24vDC ATEX II 2 G Ex ia IIB/C T6 Ga, IEC Ex ia IIB/C T6 Ga, (Ambient -40°C to +50°C) (Ref: 125930.1-00/5146) **Included**  
 ATEX Connector PG9 – DIN 43650 A (611-201-1291) and ATEX 3 way Armature (1237 07.6-00) **Included**  
 EC Certificate PTB 02 ATEX 2154 and IECEx PTB 08.0023 **Included**  
 24vDC ATEX II 2 G Ex ia IIB/C T4 Ga, IEC Ex ia IIB/C T4 Ga, (Ambient -40°C to 85°C) (Ref: 125950.1-00/5146) **+£0.00**

#### ELECTRICAL DATA

Voltage (-10% + 10%) Continuous duty 100%	Coil	Power Consumption	Insulation class	Enclosure	Electrical connections
= 24 (DC)	125930.1-00/5146	1.6 Watts	F 155°C	IP 65 with connector	3 spades DIN 43650A DIN 40050 VDE 0110
Temperature +20C +50°C +85°C	Minimum Switching Power Supply 37mAmp 37mAmp 37mAmp			Nominal Resistance of solenoid 275 ohm 310 ohm 350 ohm	
Supply for connection to intrinsically safe circuits of category ia	Maximum Values Ui <= 28V L=Li <= 115 mA Pi <= 1.6 W		The effective inductance and capacitance of the solenoid are negligibly low. Li ~ 0 Ci ~ 0		

The solenoid must be connected by inserting related intrinsically safe work equipment (Isolating barrier) in accordance with the manufacturer's instructions.

#### CONSTRUCTION

Body: Brass, Tube and internal parts: Stainless steel, Seals and gaskets: NBR  
 Exhaust M5, Moulded coil: ThermoSet Resin

#### REPAIR KIT

Armature + Tube Assembly	123707.6-00
Coil (ExialICT6)	125930.1-00/5146
Coil (ExialICT4)	125950.1-00/5146
ATEX Connector	611-201-1291

#### OVERALL DIMENSIONS

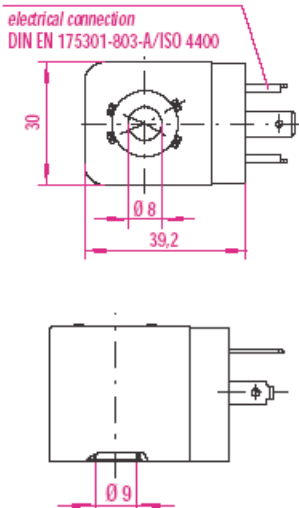

Port	1/8	1/4
A	22	25.4
B	22	35
C	72	75
D	15	18
E	11	17.5
F	22	25.4
G	7.5	12.7
H	M4 P0.7*L6.5	M5 P0.8*L7.0

