

Media: air
 Pressure range: 1.5 to 8 Bar max
 Media temperature: +50°C max
 Ambient temperature: -10°C to +50°C max
 Mounting: any position
 Weight (including coil): 115,180g
 Open and close time: 80 mSec



3/2 Single/Double Solenoid

1/8 1/4" 18mm Width

3/2 Normally Closed or Open

SERVO ASSISTED

1.5 – 10 Bar

TYPE BM320

Port 1/8 BM320-01 Series

Ø Port BSP	Ø Orifice (mm ²)	Pressure Rating (Bar) ΔP		Function Coil 22000	Part Number
		Min	Max		
1/8	12	1.5	8	N/Closed	BM320-01S + voltage
				N/Open	BM320N-01S + voltage



Port 1/4 BM320-02 Series

Ø Port BSP	Ø Orifice (mm ²)	Pressure Rating (Bar) ΔP		Function Coil 22001	Part Number
		Min	Max		
1/8 1/4	16	1.5	8	N/Closed	BM320-02S + voltage
				N/Open	BM320N-02S + voltage



OPTIONS

IP65 Coil & Connector PG9 – DIN 43650 B & manual over ride (option flying lead wire coil F)
 LED IP65 coil
 NPT Thread
 ATEX EExmIIT4 II 2G & 2D IP65 T130°C (1/4" only) 
 BM320D double acting version BM320D

ELECTRICAL DATA

Voltage (-10% + 15%) Continuous duty 100%	Coil	Power Consumption	Insulation class	Enclosure	Electrical connections
24 - 110 - 230 (50 or 60 Hz) 12 - 24 - 48 - 110 (DC)	22000	2.5 Watts	F 155°C	IP 65 with connector	3 spades DIN 43650B DIN 40050 VDE 0110
	22001	4.5 Watts			

CONSTRUCTION

Body: Anodised Aluminium
 Tube and internal parts: Stainless steel
 Seals and gaskets: NBR
 Moulded coil: Resin

OVERALL DIMENSIONS

BM320-01S

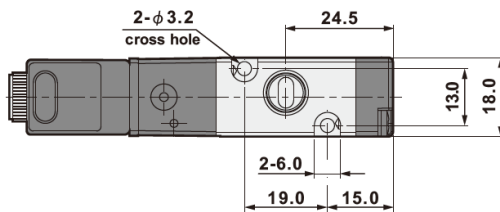

BM320-02S

