

Media: air – water – gas – light oil
 Pressure range: 0.5 to 15 Bar max
 Media temperature: -40°C to +120°C max
 Ambient temperature: -40°C to +60°C
 Media viscosity: 50 centistokes max
 Mounting: coil upright
 Opening / Closing time: 50 mSec Max

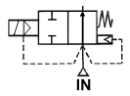

NO

2/2 Brass

3/8 – 3"

NORMALLY OPEN

2 WAY SERVO ASSISTED

0.5 – 15 Bar

TYPE NOPU225®



PRESSURE

Ø Port BSP	Ø Orifice (mm)	Flow Kv Ltr/ min	Coil	Pressure Rating (Bar) ΔP		Max Working	Seals	Max Media Temp. °C	Part Number
				Min	Max				
3/8	13	40.0	22003	0.5	10	15	NBR FKM EPDM	80 120 120	NOPU22503 + voltage NOPU22503V + voltage NOPU22503E + voltage
1/2	13	40.0	22003	0.5	10	15	NBR FKM EPDM	80 120 120	NOPU22504A + voltage NOPU22504AV + voltage NOPU22504AE + voltage
3/4	25	165.0	22003	0.5	10	15	NBR FKM EPDM	80 120 120	NOPU22506A + voltage NOPU22506AV + voltage NOPU22506AE + voltage
1	25	165.0	22003	0.5	10	15	NBR FKM EPDM	80 120 120	NOPU22508A + voltage NOPU22508AV + voltage NOPU22508AE + voltage
1 1/4	38	367	22003	0.5	10	15	NBR FKM EPDM	80 120 120	NOPU22512A + voltage NOPU22512AV + voltage NOPU22512AE + voltage
1 1/2	38	500	22003	0.5	10	15	NBR FKM EPDM	80 120 120	NOPU22514A + voltage NOPU22514AV + voltage NOPU22514AE + voltage
2	50	600	22003	0.5	10	15	NBR FKM EPDM	80 120 120	NOPU22520A + voltage NOPU22520AV + voltage NOPU22520AE + voltage
2 1/2	65	1050	16W	0.3	10	15	NBR FKM EPDM	80 120 120	NOPU22524A + voltage NOPU22524AV + voltage NOPU22524AE + voltage
3	75	1380	16W	0.3	10	15	NBR FKM EPDM	80 120 120	NOPU22528A + voltage NOPU22528AV + voltage NOPU22528AE + voltage

OPTIONS

IP65 Coil & Connector PG9 – DIN 43650 A
 ATEX 22003EX Coil: ATEX EExmIT4 II 2G & 2D IP65 T130°C (21/2 + 3" Custom made)
 NPT Thread (Not available 21/2 + 3")

Included

ELECTRICAL DATA

Voltage (-10% + 10%) Continuous duty 100%	Coil	Power Consumption		Insulation class	Enclosure	Electrical connections
		Inrush	Holding			
~ 12 - 24 - 48 - 110 - 240 - 380 (50/ 60 Hz)	22003	23VA	17VA	H 180°C	IP 65 with connector	3 spades DIN 43650A DIN 40050 VDE 0110
= 12 - 24 - 48 - 110 - 220 (DC)		15 Watts				
~ 24 - 48 - 110 - 230 - 380 (50/ 60 Hz)	16W	25VA	15VA	F 155°C		
= 12 - 24 - 48 (DC)		16 Watts				

CONSTRUCTION

Body: Forged Brass SS41
 Tube and internal parts: Stainless steel
 Seals and gaskets: NBR (Optional EPDM & FKM & HNBR)
 Moulded coil: 16 W Resin / 22003 DuroPlast ThermoSet Resin

REPAIR KIT

Diaphragm Seal	225 + size code (03-28) + seal material
Coil	Coil size (22003 or 16W) + voltage
Armature assembly (Normally Open)	225320VNO (not 21/2 + 3")

OVERALL DIMENSIONS

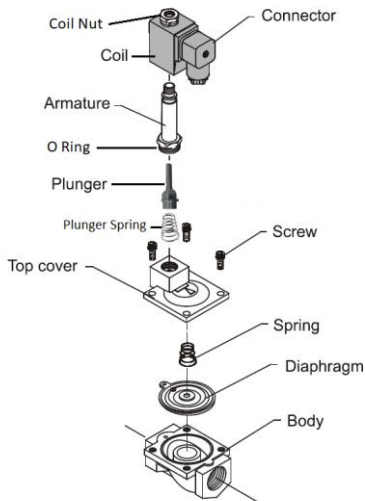

Port	3/8	1/2	3/4	1	1 1/4	1 1/2	2	2 1/2	3
A	66.5	96	131	160	243	250			
B	106.5	126.5	145.5	160.5	178	188			
C	48	70	96	112	184	184			
Kg	0.725	1.565	2.56	3.9	9.4	11.4			

