

SERIES : 52S

5/2 INTERNAL PILOT OPERATED, DOUBLE SOLENOID VALVE

TYPE	PRESSURE

TYPE	PRESSURE

TYPE	PRESSURE
57440	2 - 10 bar
57441	2 - 16 bar

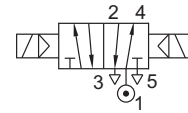

FEATURES

- Bubble tight shut off
- Mounts in any position
- Vibration resistance up to 9g
- Suitable for high speed cycling
- Speed up to 900 cycles/ min
- Life >20 million cycles

WETTED PARTS

Code	※	B1	B2	B5
Body	Anodized Aluminium	Anodized Aluminium	Brass	SS 316
Internals	Aluminium, Brass and SS 316	SS 316	Brass and SS 316	SS 316
Guide Assembly	SS 304			
Shadow-Ring	Copper/ Silver/ None			
Plunger, Insert	SS 430			
Spring	SS 302			
Fasteners	SS 304			
Seat, Seals	NBR, Viton, F Silicon			

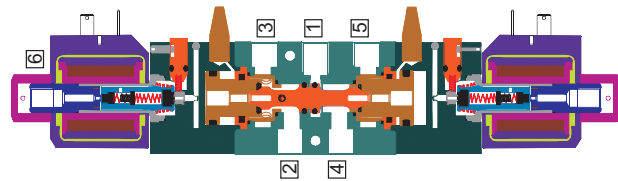

AMBIENT AND FLUID TEMPERATURE

-20 °C to 80 °C

SPECIAL VERSION AND SUFFIX

Suffix : (Valve) AM, WO
Special version : (Solenoid) CO, FR, SS, LC, III

MEDIA

Air, Inert Gases, Water, Oil

APPLICATION

Operation of double acting cylinder/ actuator

PORT CONNECTION

INLET	OUTLET	OUTLET	EXHAUST	EXHAUST	PILOT EXHAUST
1	2	4	3	5	6

- Contact Rotex for
- Any other ambient, fluid temperature, media and application
 - UL listed, Listed general purpose Valve
 - SIL4 approved valve



SPARES

(Refer page 25 for ordering code)

SPARE KIT	CODE
Seal Kit : Oring Set and Plunger Assembly	98
Repair Kit : Oring Set, Plunger Assembly, Fastener, Springs, Manual Override	99
Solenoid Kit : Solenoid, Gasket and Nut	34

APPROVAL

(★ applied for)

Approval	Nema 4X	IP67	Ex d IIC T4 or T5 or T6 IP66	Ex ia IIC T6 IP67	DGMS	CCOE
		✓	✓	✓	✓	✓
		✓	✓	✓		
	✓		*			
			✓	✓		
			✓	✓		
			✓	✓		



5/2 INTERNAL PILOT OPERATED, DOUBLE SOLENOID POPPET VALVE

SPECIFICATION

PORT CONNECTION			PRE-SURE bar		ORIFICE (mm) FLOW FACTOR kv (LPM OF WATER @ 1 bar ΔP)	VALVE TYPE	PILOT PRESSURE	BODY MATERIAL AND INTERNALS					SEALS				MANUAL OVERRIDE		SOLENOID ENCLOSURE		SUFFIX	POWER VA		CONSTRUCTION REFERENCE NUMBER			
SIZE	BSP(F)	NPT(F)	MINIMUM	MAXIMUM				ALUMINIUM	ALUMINIUM + SS	BRASS (STD PORT NPT)	SS 316/CF8M (STD. PORT NPT)	NBR	Viton	EPDM	HYTREL	F SILICON	NIL	STAYPUT CUM MOMENTARY	FLYING LEAD	PLUG IN, IP67		SQ. PLUG IN, IP67	TERMINAL BOX IP67		Ex d IIC, T4 OR T6, IP67	LARGE ENCLOSURE	SOLENOID SIZE

5/2 DUAL SOLENOID

1/4"	2G	2R	2	10	6	14	57440A	×	B2	B5	×	S2	S19	M0	×	F	22	25	T	E	III	14	✓	18	12	8	537
			2	16	6	14	57441	×	B2	B5	×	S2	S19	M0	×	F	22	25	T	E	III	14	✓	18	12	8	537
1/2"	4G	4R	2	10	12	50	57440	×	B2	B5	×	S2	M0	×	F	22	25	T	E	III	14	✓	18	12	8	538	
			2	16	12	50	57441	×	B2	B5	×	S2	M0	×	F	22	25	T	E	III	14	✓	18	12	8	538	
1"	8G	8R	2	10	25	100	57440	×	B5	×	S2	M0	×	F	22	25	T	E	III	14	✓	18	12	8	539		
			2	16	25	100	57441	×	B5	×	S2	M0	×	F	22	25	T	E	III	14	✓	18	12	8	539		
			2	10	25	100	57440V01		B2F	×	S2	M0	×	F	22	25	T	E	III	14	✓	18	12	8	539A		
1 1/2"	12G	12R	2	10	40	410	57440V01		B12	×	S2	M0	×	F	22	25	T	E	III	14	✓	18	12	8	539A		

Cable Entry	T	E	F	×	∗ = Do not specify when opted for
M20 x 1.5	19	39	Flying lead IP54	∗	∗ = Options available
1/2" NPT	16	37	Flying lead IP67	01	

ORDERING CODE AND EXAMPLE VALVE + SOLENOID

TYPE – SUFFIX – ORIFICE – PORT CONNECTION – BODY AND INTERNALS – MANUAL OVERRIDE – SEAL + SIZE – VOLTAGE – CURRENT – SOLENOID ENCLOSURE – APPROVAL – INSULATION – SPECIAL VERSION
 e.g. 57440-25-8R-B2+24V DC-22

DIMENSIONS

All Dimensions are in mm

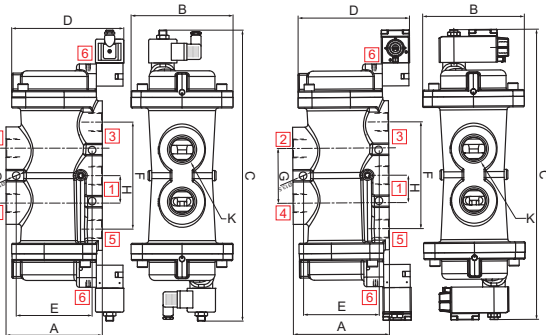

PLUG IN SOLENOID TYPE 22/ 25

TERMINAL BOX/ Ex d LARGE ENCLOSURE, TYPE 16, 19, 37, 39

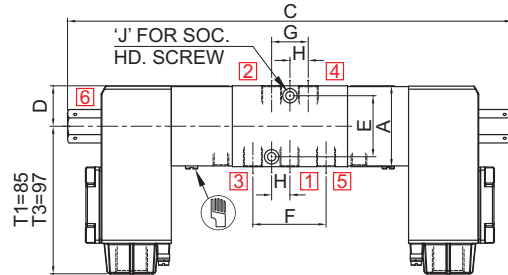
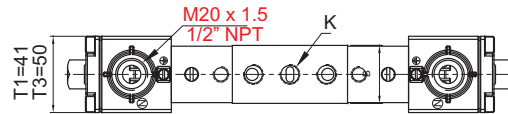

TERMINAL BOX/ Ex d LARGE ENCLOSURE, TYPE 16, 19, 37, 39

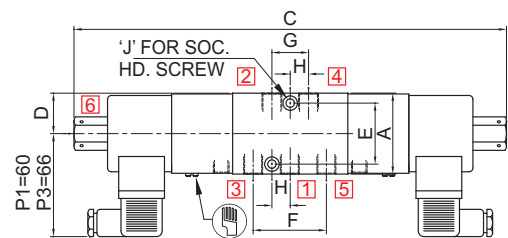
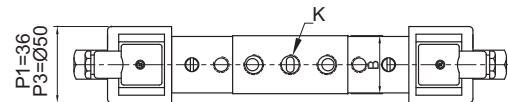

PLUG IN SOLENOID TYPE 22/ 25

K (PORT SIZE)	A	B	C	D	E	F	G	H	J	CONST. REF.
VALVE TYPE : 57440, 57441										
1/4"	53	38	289	27	40	48	24	12	M6	537
1/2"	75	45	332	38	50	72	36	18	M6	538
1"	110	65	386	55	80	112	56	28	M8	539
VALVE TYPE : 57440V01										
1"	110	95	366	100	80	112	54	27	M8	539A
1 1/2"	170	180	514	198	134	184	92	47	M8	539A