

Media: air – water – light oil - steam
 Pressure range: 0.5 to 10 Bar max
 Media temperature: +185°C Max
 Ambient temp: -20°C to +60°C
 Media viscosity: 20 centistokes max
 Mounting: coil upright

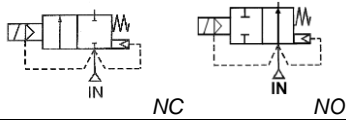

2/2 Stainless Flanged

DN15 – DN50
 N/CLOSED & N/OPEN
 2 WAY SERVO ASSISTED
 0.5 – 10 Bar
 TYPE SUSF



PRESSURE

Ø Port PN16	Ø Orifice (mm)	Flow Kv Ltr/min	Pressure Rating (Bar) ΔP		Part Number
			Min	Max	
DN15	17	66.7	0.5	10	SUS15F + voltage
DN20	17	66.7	0.5	10	SUS20F + voltage
DN25	22	200	0.5	10	SUS25F + voltage
DN32	30	300	1	10	SUS35F + voltage
DN40	30	367	1	10	SUS40F + voltage
DN50	50	800	1	10	SUS50F + voltage

OPTIONS

IP65 Coil & connector DIN 43650A PG9
 Normally Open (No ATEX option)
 ATEX 22003EX Coil: ATEX EExmIIT4 II 2G & 2D IP65 T130°C (Type SKSxxF)
 ANSI150Lb, JIS10K or other flange

ELECTRICAL DATA

Voltage (-10% + 10%) Duty rating 100%	Coil	Power Consumption (AMP)			Insulation class	Enclosure	Electrical connections
		24VDC	110vAC	230vAC			
~ 110 - 230 (50 or 60 Hz)	M		0.19	0.1	H 180°C	IP65 with connector	3 spades DIN43650 A DIN 40050 VDE 0110
= 24 (DC)		0.95					

CONSTRUCTION

Body: CF8M Stainless steel
 Tube and internal parts: Stainless steel
 Seals and gaskets: PTFE
 Moulded coil: Resin

REPAIR KIT

Coil	M + Voltage
Armature Assembly	SP – Valve Part Number + ARMATURE
Piston	SP + Valve Part Number + PISTON

OVERALL DIMENSIONS

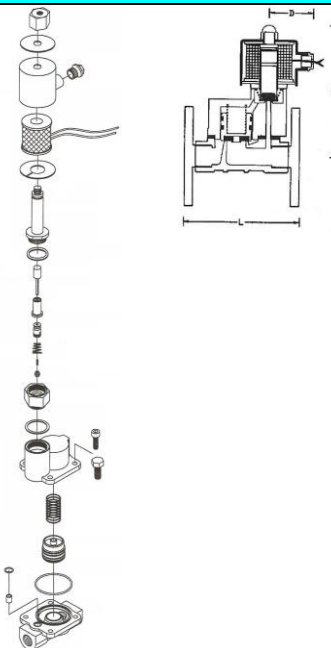

	L	H	D	Kg
SUS15	120	115	48	2.5
SUS20	120	120	48	3
SUS25	149	132	48	4.3
SUS35	170	142	48	5.6
SUS40	170	146	48	6.1
SUS50	211	173	48	9.6

