

Media: air – water – gas – light oil - vacuum 10<sup>-6</sup> torr  
 Pressure range: 0 to 150 Bar max  
 Media temperature: 180°C max  
 Ambient temperature: -10°C to +50°C max  
 Media viscosity: 50 centistokes max  
 Mounting: any position  
 Opening / Closing time: 20 mSec Max

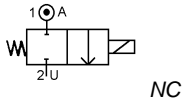

# 2/2 Brass

## 1/4

### NORMALLY CLOSED 2 WAY DIRECT ACTING

#### 0 – 150 Bar

## TYPE AD8000



### PRESSURE

Ø Port BSP	Ø Orifice (mm)	Coil	Flow Kv Ltr/min	Pressure Rating (Bar) ΔP			Seals	Part Number
				Min	Max AC	Max DC		
1/4	1.2	WPG1	1.0	0	60	42	NBR +100°C Max	AD8012 + seal + voltage
	1.6		1.3	0	40	28		AD8016 + seal + voltage
	2.0		1.6	0	20	14		AD8020 + seal + voltage
	1.2	WPG2	1.0	0	120	84	Silicone EPDM FKM 120°C Max	AD8112 + seal + voltage
	1.6		1.3	0	60	42		AD8116 + seal + voltage
	2.0		1.6	0	30	21		AD8120 + seal + voltage
	3.0		3.7	0	20	14		AD8130 + seal + voltage
	4.0		8.3	0	12	8.4		AD8140 + seal + voltage
	5.0		9.2	0	10	7		*FFKM +180°C Max (all 30 Bar Max)
	1.2	WPA3C	1.0	0	150	105	*PTFE +180°C (150 Bar Max)	AD8212 + seal + voltage
	1.6		1.3	0	80	56		AD8216 + seal + voltage
	2.0		1.6	0	60	42		AD8220 + seal + voltage
	3.0		3.7	0	40	28		AD8230 + seal + voltage
	4.0		8.3	0	20	14		AD8240 + seal + voltage
	5.0		9.2	0	15	10.5		AD8250 + seal + voltage

### OPTIONS

IP67 (EN60529:1991+A1:2000) UL + CSA Approved Coil & IP65 LED Connector PG11 – DIN 43650 A (Except WPA3C coil IP54)  
 ATEX EExmIIT4 II 2G & 2D IP65 T130°C (WPG1 Pressure same, WPG2 70% of DC rating, WPA3C not available)  
 \* PTFE, VST, Neoprene, ECO, HNBR or Hypalon Seals  
 Silver shading ring (ADxxS)  
 Manual Override  
 NPT Thread  
 Other custom-made options available upon request

### ELECTRICAL DATA

Voltage (-10% + 15%) Continuous duty 100%		Coil	Power Consumption		Insulation class	Enclosure	Electrical connections
			Inrush	Holding			
~ 24 - 110 - 230 (50 or 60 Hz)	= 12 - 24 (DC)	WPG1	11.2VA	8.2VA	H 180°C	IP 65 with connector	3 spades DIN 43650A DIN 40050 VDE 0110
~ 24 - 110 - 230 (50 or 60 Hz)			12 Watts				
= 12 - 24 (DC)	WPG2	18.7VA	15.3VA				
~ 24 - 110 - 230 (50 or 60 Hz)		18 Watts					
= 12 - 24 (DC)	WPA3C	37.5VA	27.5VA				
~ 24 - 110 - 230 (50 or 60 Hz)		22.6 Watts		IP54		30 cm flying lead wires	

### CONSTRUCTION

Body: Brass  
 Tube and Spring: 304 Stainless/ Brass Armature: 430F Stainless Other internal parts: Brass  
 Shading ring: copper (optional Silver)  
 Seals and gaskets: FKM (Optional EPDM, NBR, Silicone, PTFE, VST, Neoprene, ECO, HNBR, Hypalon, Butyl IIR)  
 Moulded coil: Resin

### REPAIR KIT

Coil	Coil size (WPG1 or WPG2 or WPA3C) + voltage
Armature + Seal	SP210 + Valve Part Number

### OVERALL DIMENSIONS

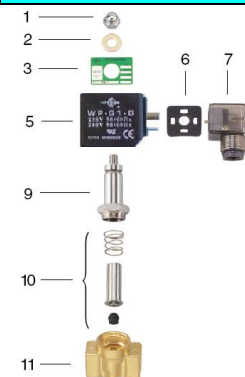

Item	Part No	Description
1	SP201-*	Nut
2	SP202-*	Washer
3	SP203-*	Nameplate
4	WP*	Coil
5	SP206-*	Gasket
6	SP207-*	Connector
7	SP209-*	Core Tube
8	SP210-*	Armature Assembly
9	SP211-*	Valve Body

\* = Valve Part Number

Model	A	B	C	F*	G	H	Kg
8012-8020	41	19	85	63	15	10.5	0.47
8112-8150	41	19	88	65	15	10.5	0.66
8212-8250	41	19	94	47	15	10.5	0.66

