

Media: air
 Inlet Pressure: 8 Bar max
 Operating Pressure range: 0.5 – 8 Bar
 Media temperature: -10°C to +60°C
 Ambient temperature: -10°C to +60°C
 Mounting: any
 Weight: 205g

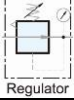

Regulator

Miniature Regulator

1/8 - 1/4
 Aluminium
 Relieving or Non Relieving
 0.5 – 8 Bar
TYPE R200 + NR200



PRESSURE

Ø Port BSP	Flow (ANR) L/Min	Regulator Type	Pressure (Bar) Air		Part Number
			Min	Max	
1/8	1500	Diaphragm	0.5	8	NR200-01
	1500	Diaphragm	0.5	4	NR200L4-01
	1500	Diaphragm	0.5	2	NR200L2-01
1/4	1550	Piston	0.5	8	R200-02
	1500	Diaphragm	0.5	8	NR200-02
	1500	Diaphragm	0.5	4	NR200L4-02
	1500	Diaphragm	0.5	2	NR200L2-02

OPTIONS

Panel mounting ring, Blanking plug x1, Relieving is standard (R200-02 option non relieving -02V),
 Pressure gauge (G),
 Mounting bracket (B)
 NPT Thread

Included

CONSTRUCTION

Body Die Cast Aluminium
 Regulator: R200 Piston 3% F.S, NR200 Diaphragm 1% F.S
 R200 10 Bar NR200 12 Bar proof pressure tested

OVERALL DIMENSIONS

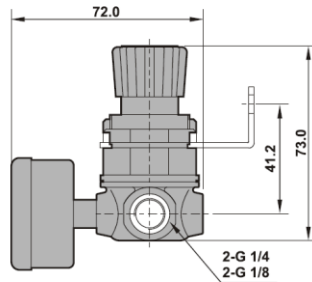
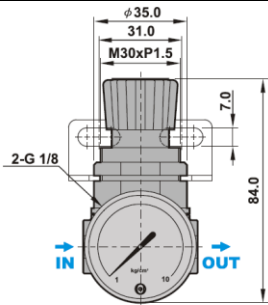

X Axis: Flow (L/min)
 Y axis: Pressure (Bar / Kgcm²)
 Blue line (P0) = Outlet pressure
 Black line (P1) = Inlet pressure
 P1 – P0 = pressure range

● R200-01, 02

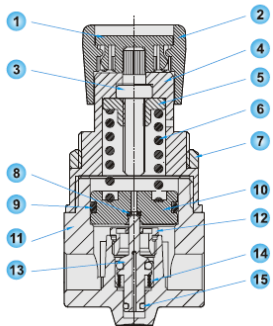

No	Description	Material
1	Regulator Dome	NY
2	Regulator Knob	NY
3	Pressure Regulating Screw	Fe+Ni
4	Regulator Base	NY+GF
5	Pressure Regulating Nut	Cu+Ni
6	Spring	Spring Steel
7	Lock Nut	NY+GF
8	O Ring	NBR
9	O Ring	NBR
10	Piston	AL
11	Body	ADC12
12	Positioning Nut	Cu
13	Regulating Needle	Cu
14	Spring	SUS
15	O Ring	NBR

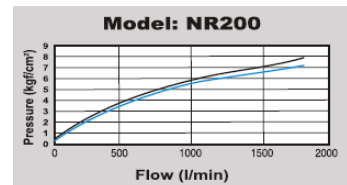
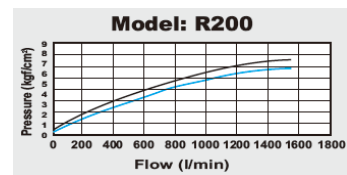

● NR200-01, 02

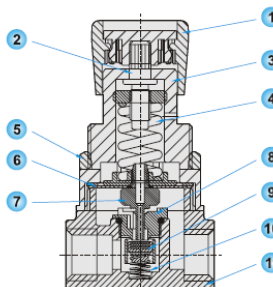

No	Description	Material
1	Regulator Knob	NY
2	Pressure Regulating screw	Fe-Ni
3	Regulator base	NY-GF
4	Spring	Spring steel
5	Lock Nut	NY-GF
6	Diaphragm	NBR70°
7	Regulating needle	AL
8	Positioning nut	POM
9	Plug	Cu
10	Spring	SUS
11	Body	ADC12