

Media: air – water – light oil - steam
 Pressure range: 0.5 to 15 Bar max
 Media temperature: -40°C to +180°C Max
 Ambient temperature: -20°C to +60° C
 Media viscosity: 50 centistokes max
 Mounting: coil upright

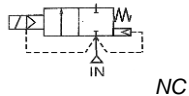

2/2 Steam Flanged

DN32 – DN50
 NORMALLY CLOSED
 2 WAY SERVO ASSISTED
 0.5 – 15 Bar
 TYPE PU225SF®



PRESSURE

Ø Port PN16	Ø Orifice (mm)	Flow Kv Ltr/ min	Pressure Rating (Bar) ΔP			Part Number
			Min	Max Gas/Fluid	Max Steam	
DN32	30	498	0.5	15	10	PU22512SF4 + voltage
DN40	32	542	0.5	15	10	PU22514SF4 + voltage
DN50	50	888	0.5	15	10	PU22520SF4 + voltage

OPTIONS

IP65 Coil & Connector PG9 – DIN 43650 A
 ATEX 22003EX Coil: ATEX EExmII T4 II 2G & 2D IP65 T130°C 
 ANSI150Lb (F3), JIS10K (F) or Other Flanges

ELECTRICAL DATA

Voltage (-10% + 10%) Duty rating 90%	Nass Coil	Power Consumption		Insulation class	Enclosure	Electrical connections
		Inrush	Holding			
~ 12-24-110-220-240-380 (50/60 Hz)	22003	22VA	17VA	H 180°C	IP65 with connector	3 spades DIN 43650A DIN40050 VDE0110
= 12-24-48-110-220 (DC)		15 Watts				

CONSTRUCTION

Body: Forged Brass; Flanges Stainless Steel, Tube and internal parts: Stainless steel
 Seals and gaskets : PTFE with 5% Graphite and 20% Glass Fibre, Moulded coil : Resin, Test pressure 30 Bar

REPAIR KIT

Coil	22003 + Voltage
Piston	SP + Valve Part Number – ARMATURE

OVERALL DIMENSIONS

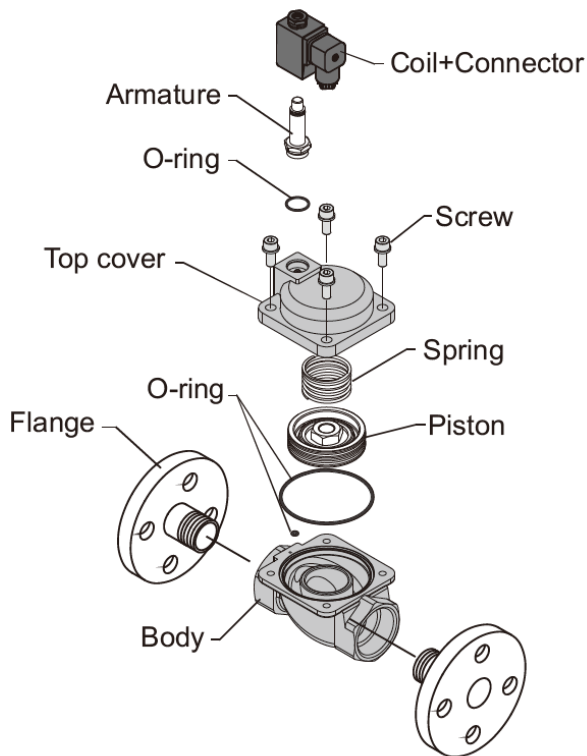

Port	A	B	C	D	F	Kg
1 1/4	182.5	70	205	140	16	4.4
1 1/2	182.5	70	205	150	16	4.4
2	212	77.5	212.3	165	18	5.6

